



Kempinski
Seychelles Resort

BAIE LAZARE

ESCAPE TO PARADISE

Kempinski

HOTELIERS SINCE 1897

A World Apart, Yet Within Reach

Explore the beauty of the Seychelles. Kempinski Seychelles Resort Baie Lazare is a beachfront paradise, located in the exclusive south-end of Mahé in a secluded bay at the foothills of a magnificent mountain range. Discover a private haven for romantics at heart, an activity-packed family getaway or the perfect destination for corporate gatherings and events.



UNIQUE SELLING POINTS

- ♦ Kempinski heritage in the Indian Ocean: a unique mix of European flair and luxury hospitality meets authentic culture in tropical surroundings
- ♦ Secluded beachfront location (64 hectares) with direct access to 800 m white sand beach
- ♦ Excellent gastronomy, combining Asian flavours with fresh, local products and refined service
- ♦ Comfortable mix of nationalities and segments, harmonious atmosphere for couples, families and groups
- ♦ An ideal location for romance and relaxation or an activity-packed getaway - hotel offers a wide range of services, from watersports to hilltop yoga and from beachfront weddings to private dining

Ideal location for couples, families & groups



COUPLES

- Kempinski The Spa
- ♦ 9:00 – 20:00
 - ♦ 6 treatment rooms. Treatments inspired by Europe's four seasons.
 - ♦ Products: Seychelles Spa and Elemental Herbology
 - ♦ Seychelles Best Resort Spa 2017

- Honeymoon and Wedding packages available
- ♦ Indoor and outdoor wedding venues including the beach
 - ♦ Wedding planning service
 - ♦ Remarkable private dining

FAMILIES

- Kempinski Kids Club
- ♦ 8:00 – 18:00
 - ♦ 4-12 years old
 - ♦ Paddling pool
 - ♦ Babysitting services available

GROUPS

- ♦ Dedicated sales team
- ♦ A la carte programs including conference, activities and meal arrangements
- ♦ Salon Quincy is one of the largest ballrooms in the Seychelles

GENERAL INFORMATION

- ♦ Currency: Seychelles Rupee, GBP, EUR, USD
- ♦ Time zone: GMT +4
- ♦ Climate: Tropical
- ♦ Visa requirements: None for Seychelles
- ♦ Language: Creole, English and French

PLACES OF INTEREST

- ♦ Island hopping
- ♦ Snorkelling and diving
- ♦ Hiking and nature trails
- ♦ Victoria Market, 25 km
- ♦ Eden Island, 24 km
- ♦ Takamaka Distillery, 18 km
- ♦ Sauzier Waterfall, 19 km

DIRECTIONS

- ♦ Located in Baie Lazare in the south west of Mahé
- ♦ Airport: 18 km / 30 min
- ♦ Victoria: 28 km / 45 min

RESORT FACTS

- ♦ Direct access to 800 m white sand beach
- ♦ Beautifully maintained tropical gardens - 64 ha

Room Categories

A collection of spacious rooms and suites set in expansive tropical grounds, have been designed to blend harmoniously with their spectacular natural surroundings.



SPLIT LEVEL INTERIOR

- Check in time: 15:00
- Check out time: 12:00
- 148 rooms
- 4 categories

GUEST ROOM FACILITIES:

- Private balcony or terrace
- Separate bedroom level and seating area with sofa bed
- Interactive TV
- Complimentary Wi-Fi
- In-room safe
- Refrigerated private bar
- Hair dryer
- Tea/coffee making facilities
- Iron and ironing board
- Complimentary soft drinks on arrival

142 ROOMS

Features

- 42-46 sq m split level bedroom with king size bed
- Luxurious bathroom with separate make up area
- Maximum capacity: two adults + one child + one infant
- Connecting rooms available
- 44 twin rooms available

Categories

- 50 Hill View Rooms: ground floor or first floor / view to hill and private lagoon
- 48 Sea View Rooms: first floor / view to ocean and tropical garden
- 44 Sea View Garden Rooms: ground floor / view to ocean and tropical garden / direct

access to garden and beach / one disabled room available

6 SUITES

Features

- Room sizes 76-85 sq m
- One bedroom suites with king size bed and separate living room (sofa bed) and dining area
- Connecting rooms available

- Maximum capacity: three adults + one child + one infant

Categories

- 4 Hill View Suites: ground floor or first floor / terrace or balcony / hill and lagoon views
- 2 Sea View Garden Suites: ground floor / terrace / view to ocean and garden / direct access to garden and beach

Hotel Services & Facilities

SERVICES & AMENITIES

- 24-hour in-room dining
- Laundry, dry-cleaning and ironing services
- Complimentary parking
- Car parking and rental service
- Tours and excursions
- Gift Shop
- Helipad

RESTAURANTS & BARS

Café Lazare

- Buffet restaurant
- Breakfast and dinner (HB)
- International cuisine, theme dinners
- 7:00 -- 10:30 | 19:00 – 22:30

L'Indochine

- Fine dining - dinner only
- Dress code: smart casual
- Gourmet, Asian fusion
- 19:00 – 22:30

Planters Bar & Lounge

- Gastropub, sushi and tapas, drinks throughout the day
- Live music entertainment every evening
- 8:00 – 1:00

Windsong Beach Restaurant

- Lunch and dinner
- Light dishes, casual dining, drinks throughout the day
- 11:00 – 22:30

Private Dining

- Breakfast on the beach
- Picnic on the hill
- Sushi on the beach
- Remarkable dinner venues: beach, lagoon, wine cellar

LEISURE & RECREATION

Included:

- 24-hour fitness centre
- 50 m swimming pool
- Aqua gym
- Two floodlit tennis courts (equipment: rackets and balls)
- Cycling
- Beach volleyball
- Soccer

- Petanque
- Golf Putting
- Nature trails
- Snorkelling (masks, fins, reef shoes)

Chargeable:

- Hilltop yoga and pilates
- PADI dive centre
- Snorkelling tours
- Kayaks and kayak tours
- Glass bottom kayaks
- Stand-up paddling
- Surfing
- Fishing trips
- Excursions
- Kempinski The Spa

Meetings & Events Plan

GROUND FLOOR: LAGOON ADJACENT

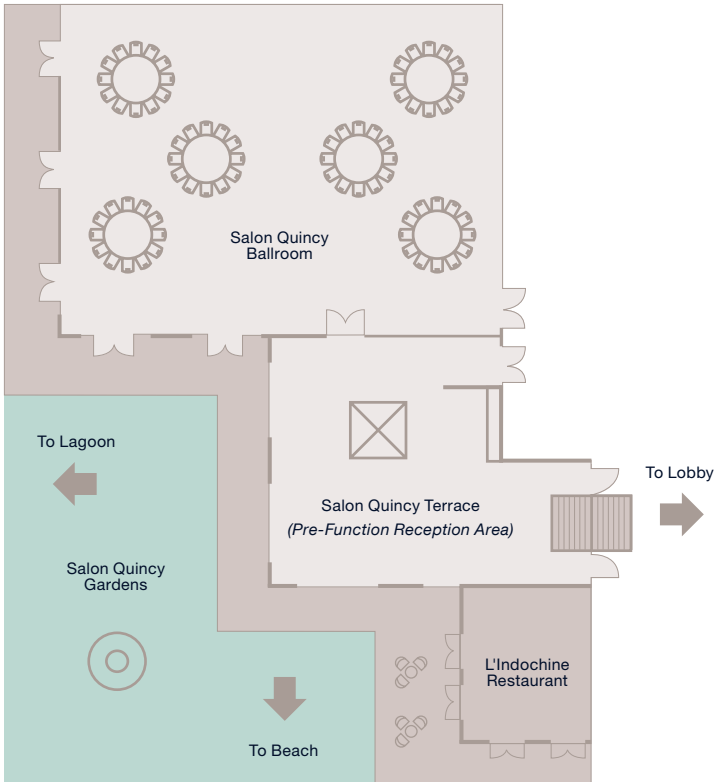

FIRST FLOOR: LOBBY ADJACENT

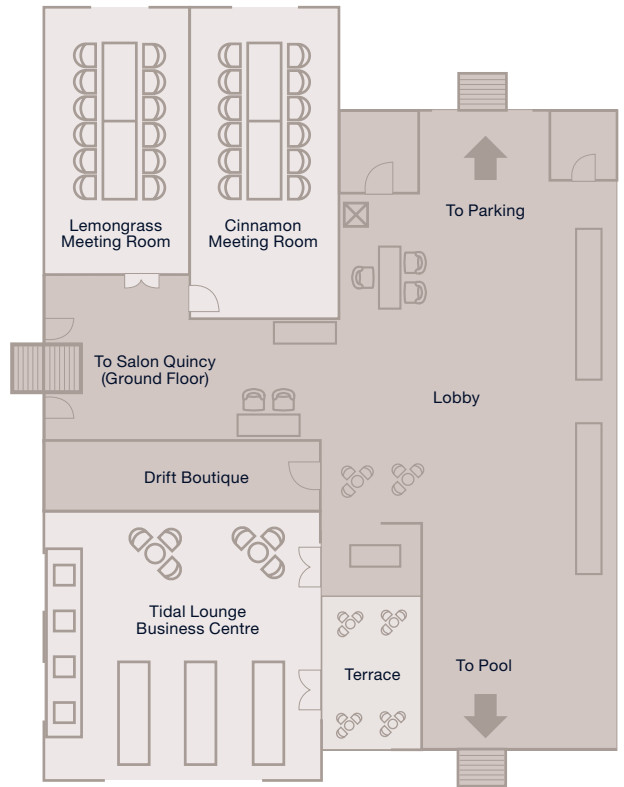

| ROOM | FLOOR AREA | LENGTH | WIDTH | CEILING HEIGHT | RECEPTION | BANQUET | THEATRE | CLASSROOM | U-SHAPE | BOARDROOM |
|--------------|------------|--------|-------|----------------|-----------|---------|---------|-----------|---------|-----------|
| | in sq m | | | | in m | in m | in m | | | |
| Salon Quincy | 284 | 19 | 14 | 5.6 | 250 | 180 | 200 | 120 | 60 | 80 |
| Tidal Lounge | 95 | 10 | 10 | 2.8 | 50 | 40 | 60 | 40 | 30 | 30 |
| Cinnamon | 47 | 11 | 5 | 2.5 | - | - | 20 | 16 | - | 20 |
| Lemongrass | 40 | 8 | 5 | 2.5 | - | - | 12 | 10 | 12 | 10 |
| Main Beach | 862 | 33 | 14 | - | 350 | 250 | - | - | - | - |





ISLAND TRANQUILITY



ANSE SOURCE D'ARGENT



PRIVATE DINING



SECLUDED BEACHES

Contact Us

For an easy and efficient booking experience, book directly with Kempinski, via kempinski.com, through the Kempinski mobile app, or your preferred travel professional, and benefit from the best rates and service.



KEMPINSKI SEYCHELLES RESORT BAIE LAZARE

P.O. Box 1356
Victoria, Mahé Island
Seychelles

T +248 438 6666
reservations.seychelles@kempinski.com
kempinski.com/seychelles

GPS DMS: 4°45'20.9"S, 55°28'32.6"E
GPS DD: -4.7557, 55.4757